



Transfer Guide

Helping you connect

www.frankfurt-airport.com



Welcome to Frankfurt Airport! **Your flight documents** **Your baggage** **Find your connecting flight** **Your boarding gate** **Bon voyage!**

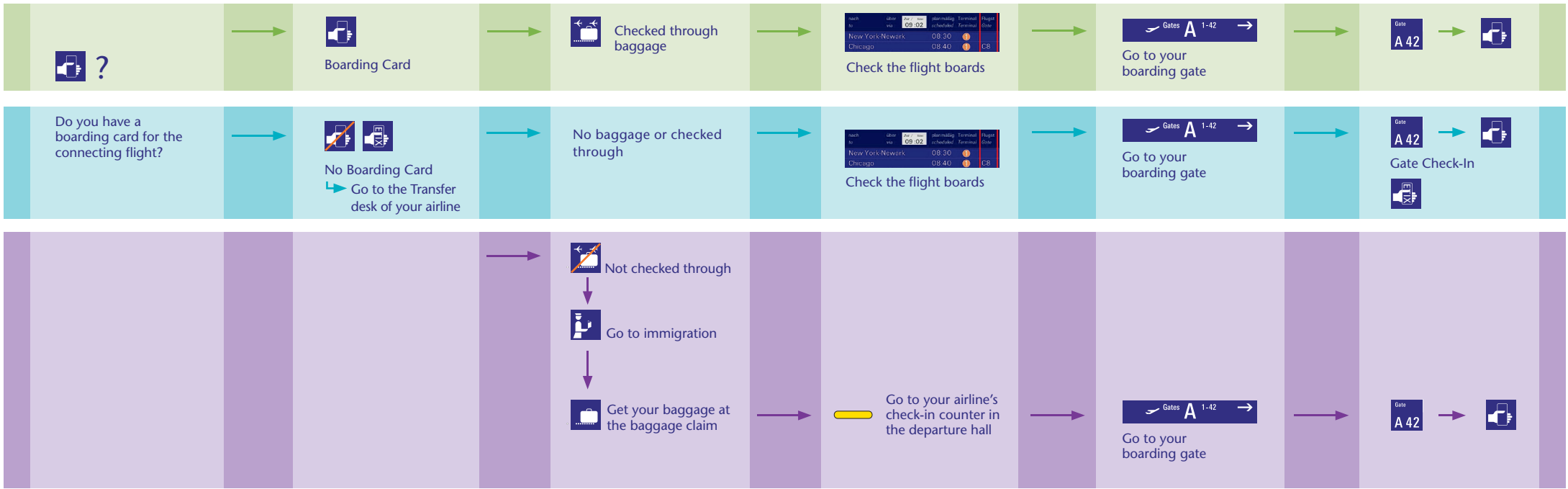

Important tips & services



Baby room
Plenty of diaper changing rooms adjacent to the toilets.

Bathrooms & showers within transit area

- Terminal 1 **B** near Gates B 30 – 33
- Terminal 2 **D** near Gates D 5 – 8
- Open 24 hours
- 6,- €

Medical services
Around the clock first aid and medical services in the airport clinic

- Telephone + 49 69 - 690-66767
- Terminal 1, access between areas B and C, Level 1
- Emergencies + 49 69 - 69 04 44 44

Pharmacies
Opening hours: daily from 7:00 a.m. to 10:00 p.m.

- Terminal 1 B, Level 2
- Terminal 2 D/E, Level 3 (near SkyLine)

The pharmacies are outside of the transit area. If needed, please ask the staff at information counter "Info 10".

Leaving the transit area
If you leave the transit area, you must pass through immigration and customs and will officially be travelling into Germany. You must therefore fulfill the entry requirements for the Federal Republic of Germany.

Punctuality
Please be on time and be aware of the boarding time of your flight!

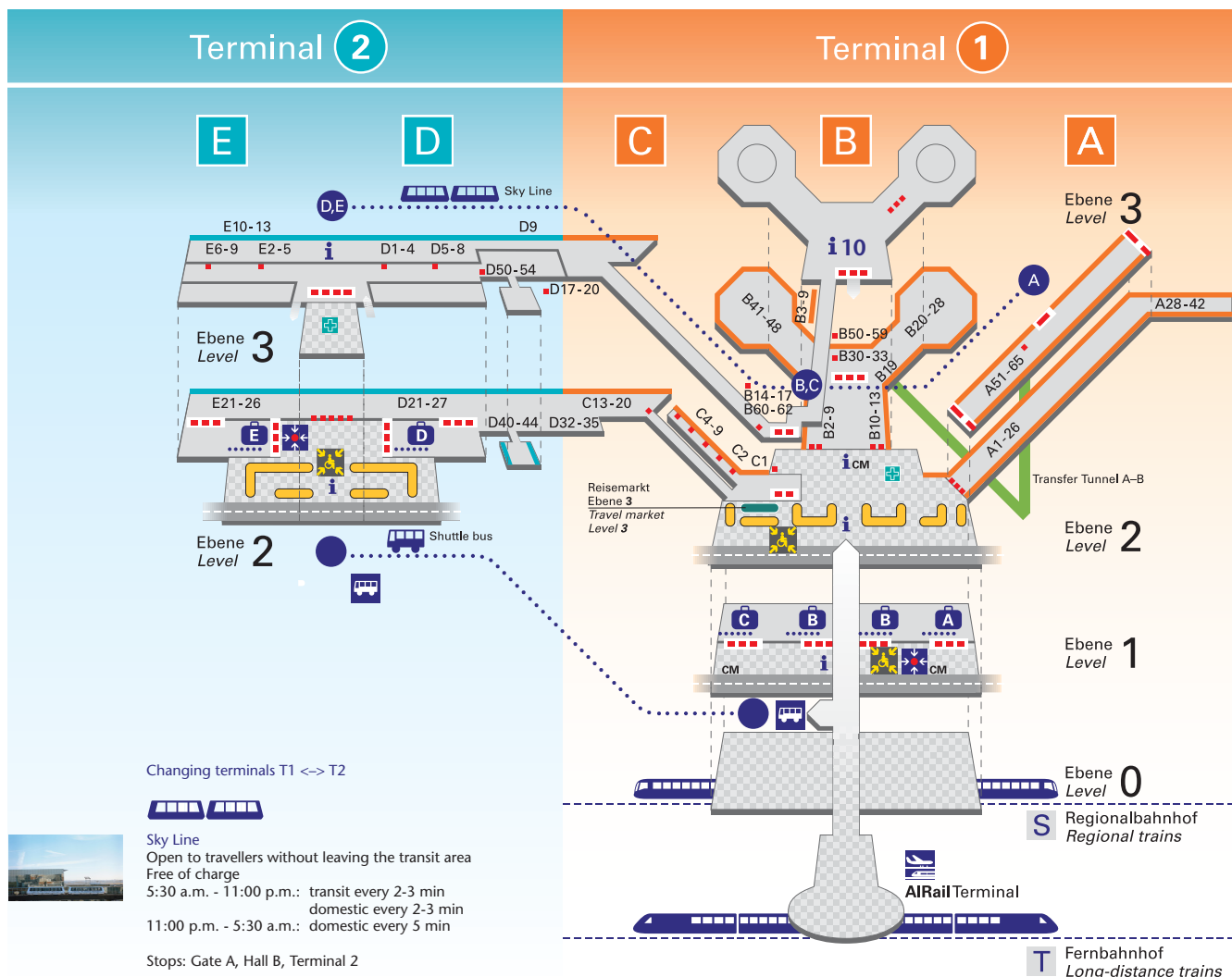

- Öffentlicher Bereich
Public area
- Kontrollierter Fluggastbereich
Restricted area
- Grenzkontrollen
Border controls
- Sicherheitskontrolle
Security control
- Gates A, B, C
- Gates D, E
- Check-in
- Transfer Tunnel A-B
Use the transfer tunnel for easy access between Halls A and B in Terminal 1.
- Apotheke
Pharmacy
- Rufsäule für Betreuung
Help points
- CM
Company Meeting
- Gepäckausgabe
Baggage claim
- Treffpunkt
Meeting point
- Pendelverkehr
Shuttle
- Zugverkehr
Railway
- i**
Information counter
Our multi-lingual staff will be more than happy to help you at any time.

Changing terminals T1 <-> T2



Sky Line
Open to travellers without leaving the transit area
Free of charge
5:30 a.m. - 11:00 p.m.: transit every 2-3 min
domestic every 2-3 min
11:00 p.m. - 5:30 a.m.: domestic every 5 min

Stops: Gate A, Hall B, Terminal 2



Bus
May only be used after leaving the transit area
Free of charge
5:30 a.m. - 11:00 p.m.: every 10 min (only domestic)

Stops:
Terminal 1 – public bus stop area
Terminal 2 – in front of door 5



HEINEMANN DUTY FREE

220 Shops, Bars & Restaurants at the Airport
Discover exclusive offers on world known brands at Frankfurt Airport! Great savings at 23 Duty Free Shops!